



DSD-37RS520 DC SPUR GEAR MOTOR

典型应用/Typical applications :

自动快锁门、装订机、自动电视架、点钞机、聚光灯、卫生纸机、办公设备、家用电器、自动执行机构

Auto shutter, binding machine, automatic TV rack, money counter, spot light, tissue machine, office equipments, household appliances, automatic actuator

DRAWING (MM)

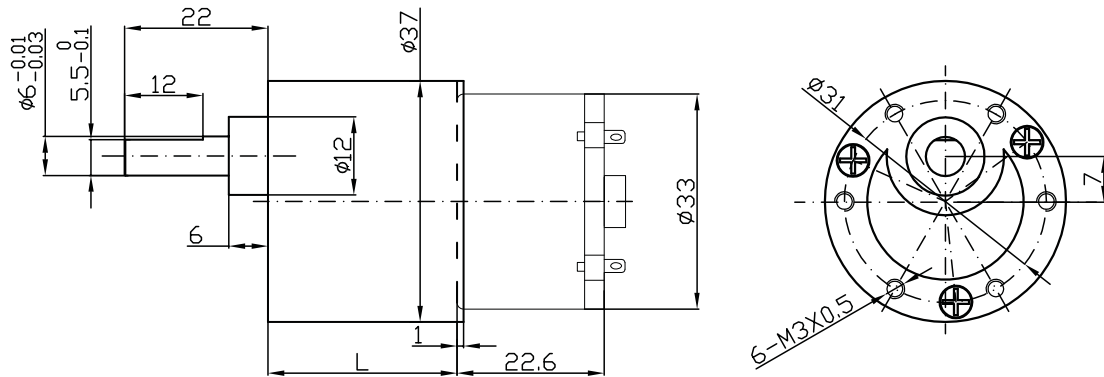

齿轮箱参数/ GEARBOX DATA:

级数 Reduction stage	2	3	4	5	6	7
减速比 Reduction ratio	6.8K, 10K	20K, 30K	61K, 90K	104K, 122K 184K, 270K	311K, 552K 414K, 810K	1243K, 1656K 2430K
齿轮箱长度 Gearbox length "L" mm	18	21.5	24	26.5	29	31.5
齿轮箱效率 Gearbox efficiency	81%	73%	65%	59%	53%	48%

电机参数/ MOTOR DATA:

电机型号 Motor model	额定电压 Rated voltage	空载/ No load		负载/ Load				堵转/ Stall	
		电流	转速	电流	转速	扭矩	功率	扭矩	电流
		Current	Speed	Current	Speed	Torque	Output	Torque	Current
	V	mA	rpm	mA	rpm	gf. cm	W	gf. cm	mA
DSD-5200063000	6	≤27	3000	≤130	2600	15	0.41	≥100	≥630
DSD-5200123000	12	≤16	3000	≤70	2400	20	0.50	≥90	≥330
DSD-5200126000	12	≤54	6000	≤150	5500	15	0.86	≥162	≥1220
DSD-52001212000	12	≤40	12000	≤135	9600	45	4.50	≥202	≥3780
DSD-5200244500	24	≤25	4500	≤90	3400	33	1.40	≥122	≥350
DSD-5200246000	24	≤30	6000	≤200	4800	38	2.30	≥171	≥660
DSD-5200249000	24	≤54	9000	≤200	7200	47	3.50	≥211	≥1670

电机参数仅供参考, 请以实际样板为准。

The motor data are for reference only, real samples may be with different specifications.

齿轮箱电机输出扭矩: 电机输出扭矩 x 减速比 x 齿轮箱效率; 齿轮箱电机输出转速: 电机输出转速 / 减速比。

Output torque of gear motor: output torque of motor x reduction ratio x gearbox efficiency;

Output speed of gear motor: output speed of motor / reduction ratio.